



## LUER Fittings

Nordson MEDICAL offers designers worldwide the broadest selection of male luer and female luer fittings and connectors, luer adapters, and luer accessories. Over 120 separate configurations are available in nylon, polypropylene, polycarbonate, and PVDF, with many color and special material options offered from stock or by special order. Our male and female luers support tubing sizes from 1/16" (1.6 mm) to 1/4" (6.4 mm) ID, with threaded ends and panel mount versions also available. ISO 80369-7 compliant designs are offered to support safer connections and reduce the risk of misconnections in medical applications.

### FEATURES & BENEFITS

- Published ISO design standard that is well understood worldwide and often assures interconnections without need to retrofit.
- Rotating lock permits tube positioning prior to tightening, minimizing twisting and kinking of tubing
- Tapered cone seal that is reliable and uncomplicated
- Available in many materials to facilitate optimal material selection for your application
- Inexpensive and easy to use
- Many configuration options that are adaptable to a wide range of applications
- Security options that are tailorable to your specific application
- Now available: ISO 80369-7 compliant luer fittings

### SPECIFICATIONS

- **Materials:**
  - Available in nylon, polypropylene, polycarbonate, polyvinylidene fluoride (PVDF), and other materials by special order.
- **Sterilization:**
  - Autoclave, Gamma radiation stable & EtO compatible

# LUER Fittings

## LUER LOCKS & LUER SLIPS

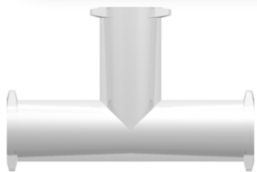

### Adapters

**Part Shown: MLRL013**

**Sizes:** No tube connection

**Materials:** Animal-Free Natural Polypropylene, Nylon, & Polycarbonate

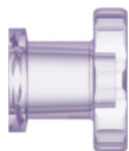

### Plugs & Caps

**Part Shown: FTLLP-9002**

**Sizes:** No tube connection

**Materials:** Animal-Free Natural Polypropylene, Nylon, & Polycarbonate

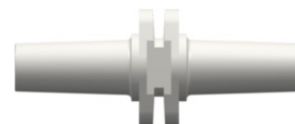

### Couplers

**Part Shown: MTLCS-1**

**Sizes:** No tube connection

**Materials:** Animal-Free Natural Polypropylene, Nylon, PVDF, & Polycarbonate



### Elbows

**Part Shown: LE87-2**

**Sizes:** 3/32" (2.4 mm) & 1/8" (3.2 mm)

**Materials:** Animal-Free Natural Polypropylene, Nylon, & Polycarbonate



### Female Luers

**Part Shown: FTLL240-6005**

**Sizes:** .170" (4.3 mm), 1/16" (1.6 mm), 1/4" (6.4 mm), 1/8" (3.2 mm), 3/16" (4.8 mm), 3/32" (2.4 mm), & 5/32" (4.0 mm)

**Materials:** Acrylic, Animal-Free Natural Polypropylene, Nylon, PVDF, & Polycarbonate



### Lock Rings

**Part Shown: MTL007-9**

**Sizes:** No tube connection

**Materials:** Animal-Free Natural Polypropylene, Nylon, & Polycarbonate



### Male Luers

**Part Shown: MLRL013**

**Sizes:** .170" (4.3 mm), 1/16" (1.6 mm), 1/4" (6.4 mm), 1/8" (3.2 mm), 3/16" (4.8 mm), 3/32" (2.4 mm), & 5/32" (4.0 mm)

**Materials:** ABS, Acetal, Animal-Free Natural Polypropylene, Nylon, PVDF, & Polycarbonate



### Panel Mounts

**Part Shown: FTLLBMLRL-6005**

**Sizes:** 1/16" (1.6 mm), 3/32" (2.4 mm), & 1/8" (3.2 mm)

**Materials:** Animal-Free Natural Polypropylene, & Nylon

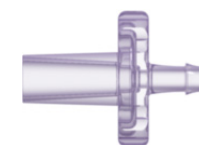

### Slip Luers

**Part Shown: MSL004-9002**

**Sizes:** 1/16" (1.6 mm), 3/32" (2.4 mm), 1/8" (3.2 mm), 5/32" (4.0 mm), 3/16" (4.8 mm), & 1/4" (6.4 mm)

**Materials:** Animal-Free Natural Polypropylene, Nylon, PVDF, & Polycarbonate

\*Additional configurations can be viewed online at [nordsonmedical.com](http://nordsonmedical.com)

## ISO 594-1 & 594-2 Standard Luers

All Nordson MEDICAL luer components meet ISO 594-1 and 594-2 standards and are compatible with other compliant fittings. For multi-supplier assemblies, test to confirm fit and performance, as not all products may fully meet these standards.

## ISO 80369-7 Luer Fittings

Nordson MEDICAL offers several ISO 80369-7 compliant SKUs, including male luer locks, female threaded luers, and end caps in nylon, polypropylene, and polycarbonate. Sizes range from 1/16" to 3/16". Explore the full line at [nordsonmedical.com](http://nordsonmedical.com).